

PRODUCT DATASHEET

Press fit valve. Suitable for copper or steel pipe, compatible with M and V profile jaws (order M version in DN35 and above for use with M profile jaws). TEA finish, lever handle.

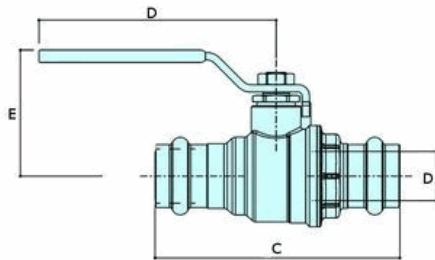

DIMENSIONS



Part No'	Size	A	B	C	D	E	F	G	H	Weight	PN	MIN °C	MAX °C
P100.15	15mm			90	15	39	75			0.20	16	-10.00	95.00
P100.22	22mm			98	22	49	95			0.40	16	-10.00	95.00
P100.28	28mm			110	28	64	120			0.60	16	-10.00	95.00
P100.35	35mm			122	35	66	120			0.90	16	-10.00	95.00
P100M.42	42mm			142	42	82	150			0.90	16	-10.00	95.00
P100M.54	54mm			182	54	89	150			2.10	16	-10.00	95.00

MATERIAL

Component	Material
Ball	BRASS Cw617N (CZ122)
Body	DZR BRASS Cw602N (CZ132)
O-Ring	EPDM
Seat	PTFE
Stem	DZR BRASS Cw602N (CZ132)
Stuffing Box	BRASS Cw614N (CZ121)

FLOW CHARACTERISTICS

P-PRESS

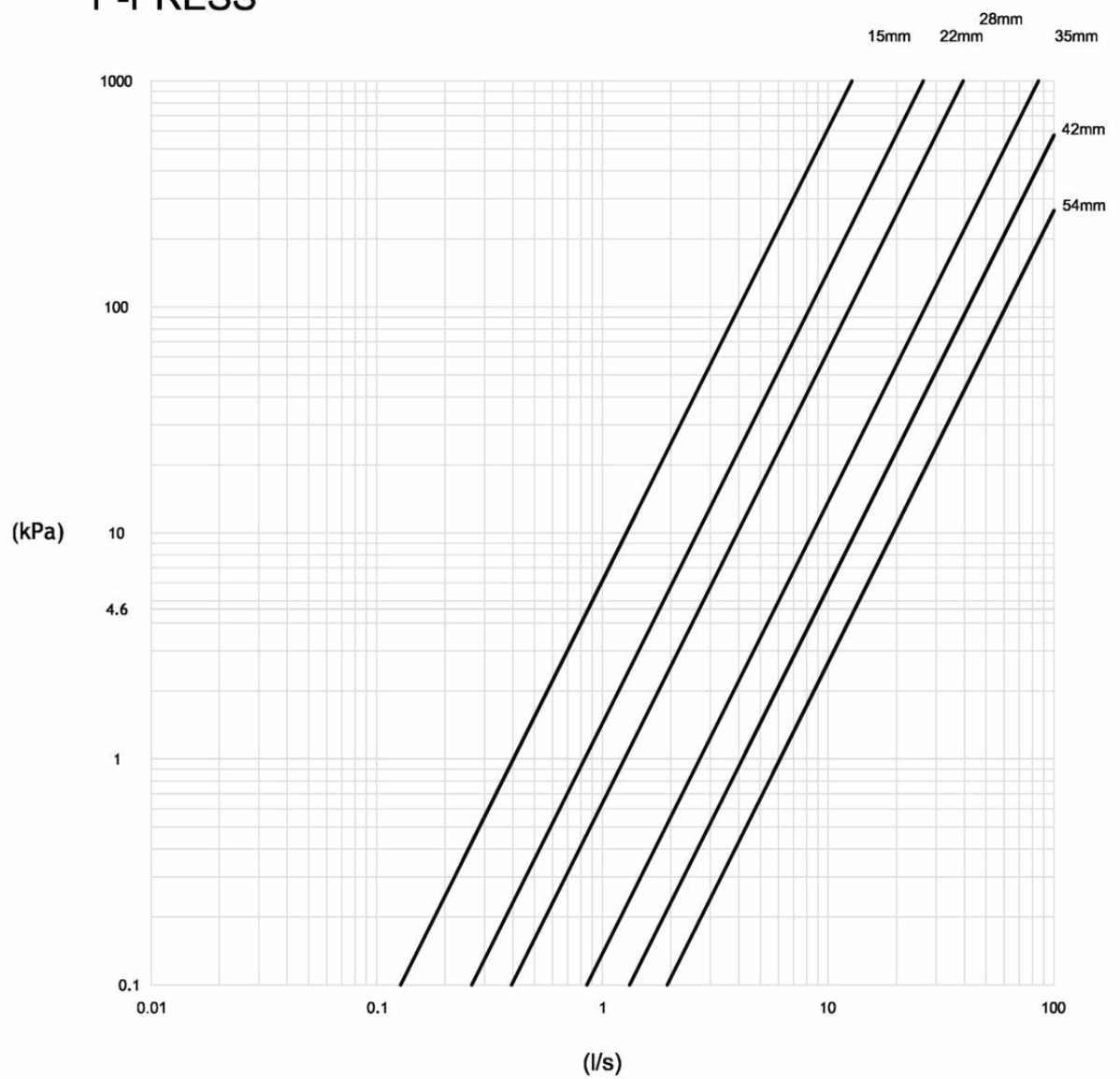

Part No'	Kv	Kvs	KV @ 30%
P100.15	14.50		
P100.22	30.00		
P100.28	45.00		
P100.35	97.00		
P100M.42	150.00		
P100M.54	220.00		

FITTING NOTES/INSTRUCTIONS

- 1) Ensure pipe ends are properly de-burred and free from sharp edges
- 2) Check the presence and condition of the O-Ring
- 3) Insert pipe into the end of the valve and mark off the maximum depth of insertion
- 4) Press fully until the press gun clicks out.

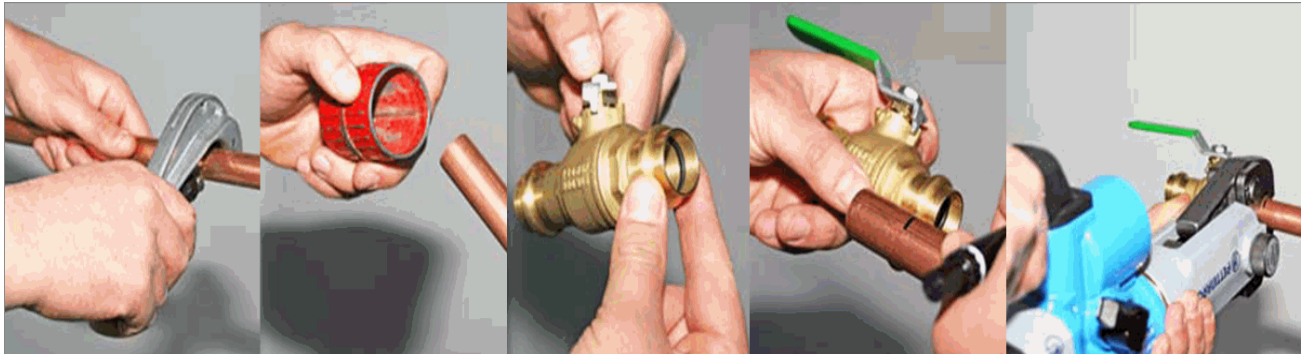

SPECIFICATION TEXT

Where isolation valves DN15 - DN50 are required a Press series ball valve with integral press fit connections should be installed. Quarter turn Isolation valve manufactured from Hot forged DZR with TEA coating and frost proofed ball, triple sealed blow out proof stem with 2 O-Rings and virgin PTFE packing gland.

As supplied by Marflow Hydraulics Ltd

Tel: 0121 358 1555

www.marflowhydraulics.co.uk